

ASSEMBLY INSTRUCTION

NO.	DESCRIPTION	Nm	Ft/Lb
<i>Use a temporary thread retainer such as Loctite #609</i>			
1	m14 Tube Nut to shock pin	47	34
2	m8 Flange Bolt to mounting plate	18	13
3	m6 aduster plate lock bolt	7	5

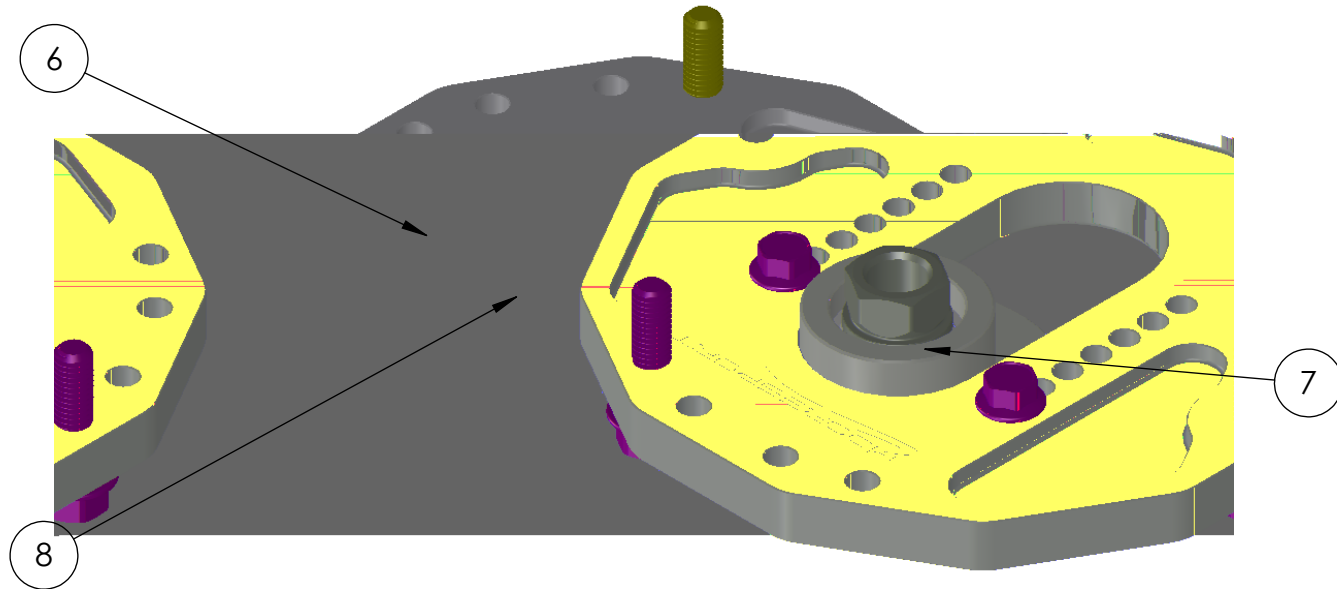

THE INFORMATION CONTAINED IN THIS DRAWING IS THE SOLE PROPERTY OF MSI (Moore-Sport INC). ANY REPRODUCTION IN PART OR AS A WHOLE IS STRICTLY PROHIBITED.



GC, GD & BRZ Front Street Camber Plate KW

CAR MODEL	GC, GD & BRZ	CONFIGURATION:	ASSEMBLY:	REV	19/05/2016
APPLICATION	Street	As Installed	MSIsub02-18-001-KW	3	SHEET 2 OF 4

180
140
100
60
20

260 220 180 140 100 60 20

